

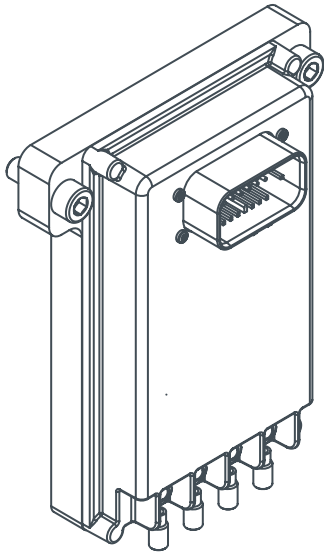

Measurement Technology & Control Concept



SmartH Valve and Motor Controllers for flanging to hydraulic manifolds

- 2 integrated pressure measuring cells
- Proportional control of up to 4 valves possible
- Proportional motor control of DC small motors realizable
- Electronics integrated in a housing made of a high pressure stable metal base plate with plastic cover
- Easy exchangeability in case of service
- Communication via CAN-bus and Bluetooth possible
- Optional control via smartphone app
- Optional X/Y inclination sensor can be integrated

Supply voltage: 12V oder 24V DC
Max. Valve Current: 1 A per valve/4x
Max. Motor current: 40 A
Measurable pressure range: 0-400 bar

Typical applications: Automated control of complete hydraulic drives, e.g. leisure industry, sales vehicles/trailers, press control, support of mobile vehicles

SmartH Pressure Measurement Technology for safe pressure monitoring on hydraulic manifolds

- 2 pressure measuring cells for condition monitoring of hydraulic manifolds, filters and aggregates
- Integration of measurement technology in a compact housing
- Housing can be flexibly mounted on any hydraulic block flanged on and measure pressure signals there
- Easy to service, exchangeable housing
- Measurement signals can be further processed by controllers and monitored, functional safety possible
- Additional digital inputs and outputs
- Communication via CAN-Bus
- Customer-specific software applications possible

Supply voltage: 12 V or 24 V DC
Pressure area: up to 250 bar
Electrical connection: M12 – 8-Pole

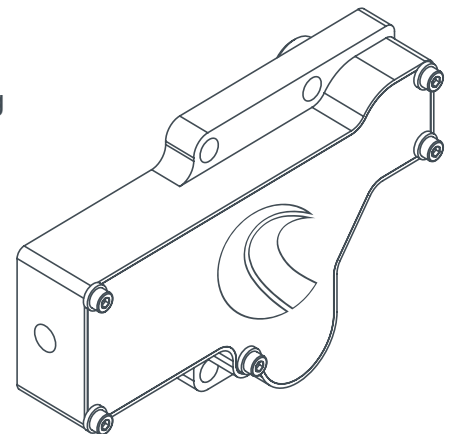

Typical applications: municipal technology, construction machinery, agricultural technology

System integration

Motor/pump unit



Smart H Measurement technology and control concept

- Variable speed drive of dynamic AC synchronous motors
- Integrated converter electronics IP67
- Communication via CAN-Bus
- customer-specific hydraulic customizations can be realized.

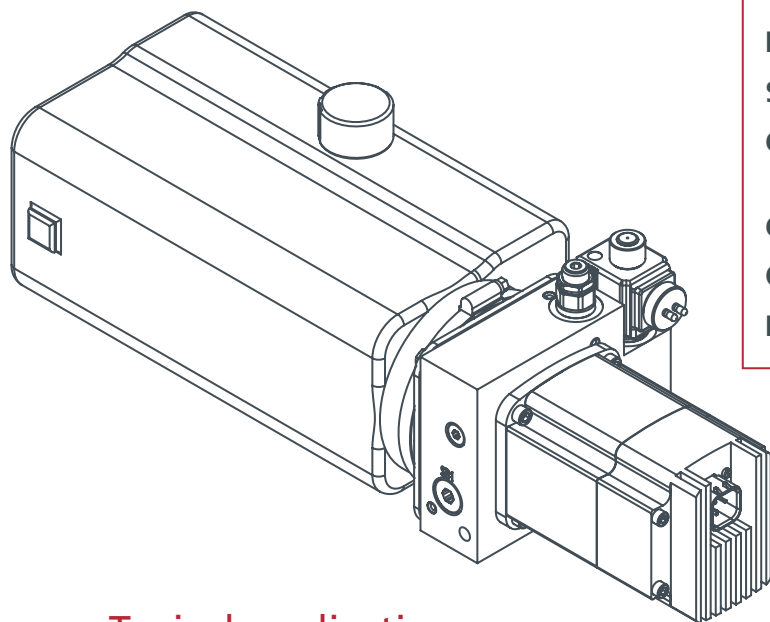

Technical Data

Performance:	520 W
Supply voltage:	12 – 48 VDC
Control:	Integrated Converter with Hall generator
Communication:	CAN J1939/CAN Open
Operating mode:	S1
Pressure area:	up to 250 bar

Typical applications

- Electrically decentralised regulated rotary and linear drives
- Controlled rotary drives
- Construction machinery
Crushers:
e. g. Belt drives, adjustment
- Agricultural machinery:
e. g. Laying drives, Belt drives

